

- Notes:
- 1 ALL DIMENSIONS ARE IN MILLIMETRES UNLESS STATED OTHERWISE.
 - 2 NO DIMENSION IS TO BE SCALED OFF THE DRAWING.
 - 3 THIS DRAWING TO BE READ IN CONJUNCTION WITH ALL RELEVANT CONSULTANT SERVICES DRAWINGS & SPECS.
 - 4 ANY DISCREPANCY IN DRG. TO BE BROUGHT TO THE NOTICE OF ARCHITECTS BEFORE COMMENCEMENT OF WORK AT SITE.
 - 5 FOR ALL STAIRS, RAMP, ELEVATORS, TOILETS - REFER SEP. DETAILS
 - 6 FOR ALL SERVICES DWGS - REFER SEP. DETAILS
 - 7 FOR CUTOUPS FOR BASEMENTS FRESH AIR - REFER SEP. DETAILS

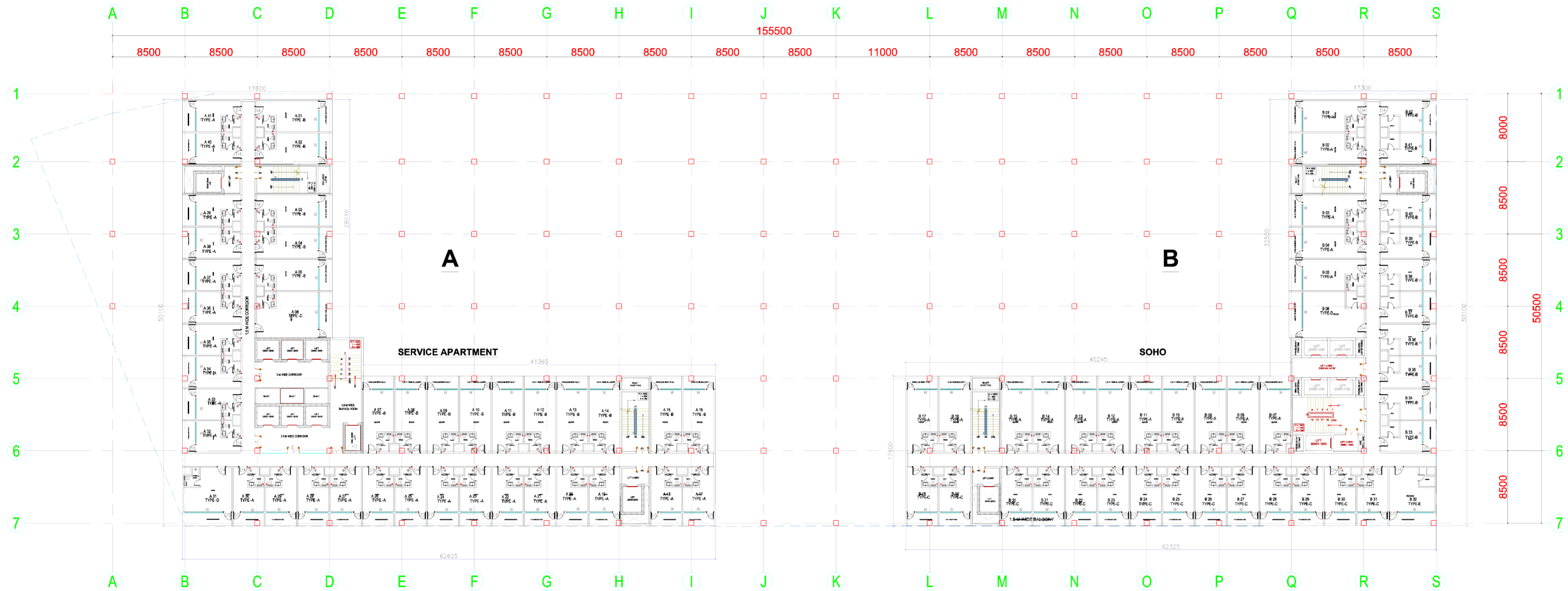

TYPICAL FLOOR PLAN
7TH,10TH,11TH,12TH,15TH,16TH,18TH,19TH

Released for :-

<input type="checkbox"/> Information	<input checked="" type="checkbox"/> Review	<input type="checkbox"/> Approval
<input type="checkbox"/> Tender	<input type="checkbox"/> Submission	<input type="checkbox"/> Good for Construction

no.	date	description

DEVELOPMENT OF SAHIBABAD BUS TERMINAL AND COMMERCIAL COMPLEX IN STATE OF UTTAR PRADESH ON PPP MODEL.

UTTAR PRADESH STATE ROAD TRANSPORT CORPORATION

M/S ANAND HABITAT SAHIBABAD DOBT & CC PVT LTD.

HOLISTICS URBAN INNOVATIONS PVT. LTD. PLANNING & ARCHITECTURE EPC & KEPC ACTIVITIES GREEN & ENERGY SERVICES BUILDING TECH. SERVICES, THE CORENTHUM, TOWER- A-41, SEC. - 62, NOIDA 201 301 PH.- 0120-4139788,4250877 E-Mail: holcons@yahoo.co.in

STRUCTURAL- ENGINEERING SOLUTIONS CONSULTING ENGINEERS THE -11JUM 701,TOWER-A, PLOT-A40,SECTOR-62 NOIDA (U.P) Ph. 0120-2404141 e-mail enggsolutions03@gmail.com

SQUARETECH ENGINEERS C-273/10, 1st. Floor, A.F. Enclave Part-II, Jamia Nagar New Delhi-110025. Landline No: +91-11-49735396 Mob: +91-9818082233. Email:- sqtechengineers@gmail.com Web: www.sqtech.in

TYPICAL FLOOR PLAN 7TH,10TH,11TH,12TH, 15TH,16TH,18TH,19TH

project no	date	north :
	13.03.2026	
drg. no		revision: R0

THIS DRAWING IS THE COPYRIGHT OF M/S HOLISTIC URBAN INNOVATIONS PVT. LTD. ITS USE FOR ANY PURPOSE OTHER THAN STATED TO BE DONE AFTER WRITTEN APPROVAL FROM M/S HOLISTIC URBAN INNOVATIONS PVT. LTD.